

Rolling Ring linear drives

Zero backlash. Jam-proof design.



Manually slide drive
using release lever

- ▶ **For positioning & reciprocating motion applications**
- ▶ **Smooth movement; ultra-low maintenance**

Uhing® Rolling Ring linear drives have zero play when the shaft is rotated – even during reversal. The threadless shaft won't clog or jam. If the system is somehow overloaded, the shaft simply slips instead of churning and grinding.

• **Example applications:** material handling machines, winding equipment, test and measurement devices, packaging & converting equipment.

• **Uhing Drives** are available separately or on shaft in custom assembly.

• **Wide range of sizes** for varying linear speeds & axial thrust requirements.

• **Simple set-up & operation**

Some models feature mechanical control over speed and travel direction – without programming or electronics.

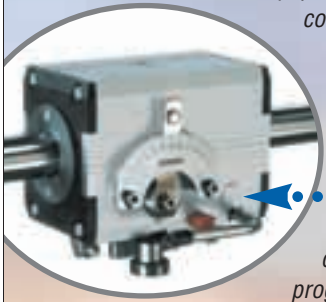

Request a Brochure or CD-ROM

1 (800) 252-2645

Email: amacoil@amacoil.com

www.amacoil.com



Distributed by Amacoil, Inc.
PO Box 2228, Aston PA, 19014
Phone: (610) 485-8300

CAD Chronicle

SMB document management

Siemens PLM Software has announced Version 3 of Teamcenter Express collaborative product data management software includes integration with Microsoft Office 2007 applications and improved view and markup capabilities in the web client. The new capabilities are said to enable more complete design-through-manufacturing data management for small- to mid-size manufacturers (SMBs) through expanded integration with the user's desktop. www.siemens.com/plm/teamcenterexpress



hyperMILL integration for SolidWorks users

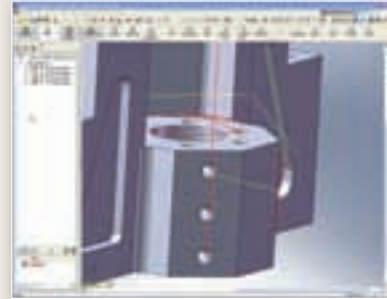

With the product release of hyperMILL V9.7, Open Mind Technologies AG is now offering SolidWorks users an integrated solution for the very first time. The CAM software is also integrated with Pro/ENGINEER Wildfire, Autodesk Inventor, thinkdesign and hyperCAD 2007. Both CAD and CAM systems access the same pool of data. A uniform data model is used during the entire process to ensure the accuracy and transparency of the manufacturing process and to prevent errors. www.openmind-tech.com

Handheld 3D laser scanners



Creaform has announced the EXAscan, a self-positioning handheld laser scanner equipped with a third high definition camera, located in the upper central section, to increase the scanning resolution as well as the data acquisition accuracy. The portable 3D scanner also has a new automatic multi-resolution function, enabling it to automatically set the optimum resolution level of the data acquired, according to the type of surface it is scanning. Units are based on the same technology found in the company's Handyscan 3D laser scanner. www.creaform3d.com

COMBINED BEARINGS + RAILS

0.1 - 100 t



Heavy Load Linearsystem

- ✓ Enables low cost designs without costly machining operations
- ✓ Stainless Steel, Vulkollan Coated, High Temperature Versions up to 500 °F
- ✓ Robust, reasonable deliveries from stock

Combined bearing 4.085
Profile St. 8 Nb 10 - 14 t

Vulkollan Coated Speed and
Silent Versions NEW SIZES
Ø 40 - 180 mm



NEW



NEW

NEW Get your
2007 catalogue now !

Information and
3D CAD online

WINKEL



Distributor for Canada

MONTREAL Tel: (514) 685-6006
TORONTO Tel: (905) 826-1100
WINNIPEG Tel: (204) 694-1455
EDMONTON Tel: (403) 465-3311
VANCOUVER Tel: (604) 294-3461

www.combined-bearings.com

Finite element analysis

Algor, Inc. has announced that its latest FEA software release, Algor V21, upgrades modeling, solution and results evaluation, and presentation. Features include a behind-the-scenes representation of the CAD model and meshing algorithms for better mesh matching and automatic contact in complex assemblies; calculation of mass transfer due to diffusion in 3D transient analysis; 3D display of 2D axisymmetric and planar model results (using rotation or thickness values); and enhanced reporting capabilities. www.algor.com



Engineering fluid dynamics

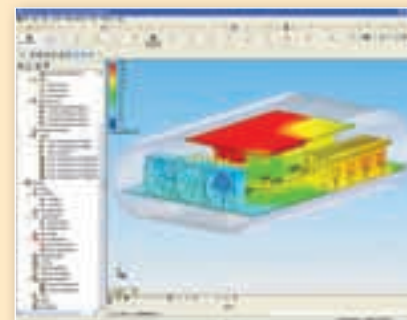

Flomerics has released Version 8.1 of its Engineering Fluid Dynamics (EFD) simulation software for thermal analysis of electronics. Functionality includes simulation of "Joule heating," as well as "compact" models for IC components, heat pipes and thermoelectric coolers. The treatment of thermal conductivity in PCBs has been improved and the simulation of fans has also been improved with radial and swirl components of velocity. www.flomerics.com

CAD-neutral design

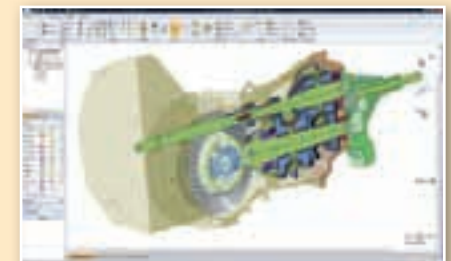

SpaceClaim Corp. has announced SpaceClaim Professional 2007+ 3D design software said to help more quickly originate concepts, make better use of existing models and freely modify mechanical designs. The release includes the ability to create sheet metal parts, as well as open and modify sheet metal parts originating in other CAD systems. Designers can also work with lightweight assemblies, drive 3D modifications via any 2D section, and integrate with CAD-neutral partner applications. www.spaceclaim.com